

Superlight & Mirror setup for 4 side guarding
 Note the light curtain offset from the Mirrors
 Light Curtain Pedestal needs to be moved in by 4.3
 from both directions

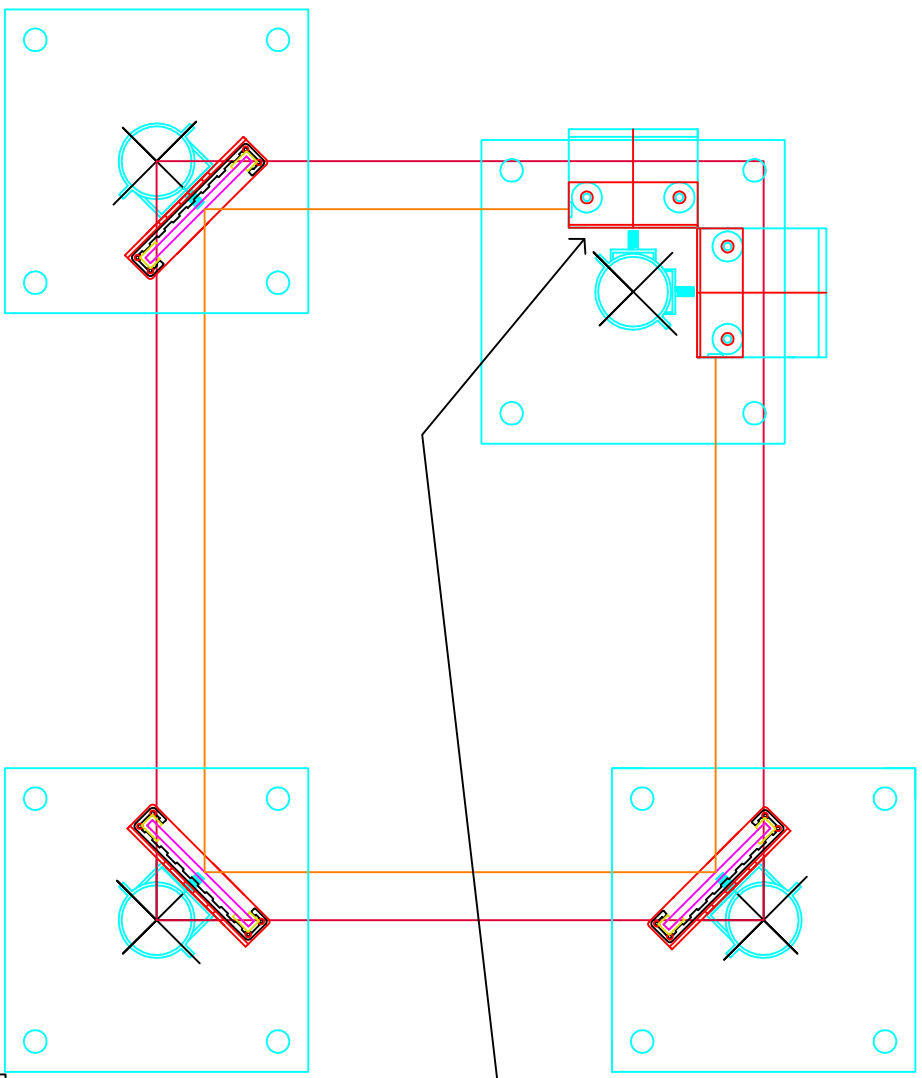

Superlight requires a
 extender to move the
 curtain .72" away
 from the Pedestal
 body

REVISIONS			
ZONE	REV	DESCRIPTION	DATE

UNLESS OTHERWISE SPECIFIED: DIMENSIONS ARE IN INCHES		Triad Controls, Inc.	
		4 Sided guarding	
		SIZE	DWG NO.
		B	28-161
		SCALE	REV
		SHEET	OF